

# Yr 10: Level 1/2 Vocational Award in Engineering (Technical Award)

## An Introduction and preparation for year 11 assessments

### Introduction to key terminology, processes and working safely



### Development of practical and machining skills

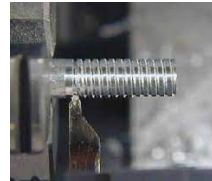
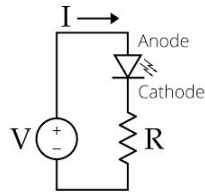

### UNIT 1: Manufacturing Engineering Products Mock Assessment

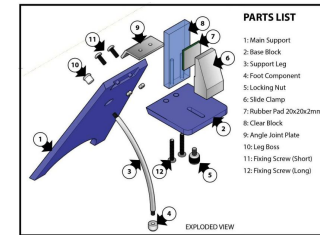

Material	Cutting Speed (m/min)	Iron tool (HSS) Feed (mm/rev)	Iron tool (HSS) Speed (rev/min)
Aluminium	500	0.050	0.800
Hard Plastic	300	0.060	0.700
Hard Wood	400	0.085	0.600
Soft Wood	500	0.070	0.710
MSI	400	0.200	0.300

Milling Feed Speeds

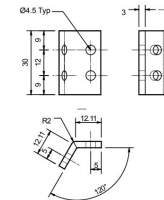

During the introductory stages you will further your Design and Technology knowledge and skills with a new focus on exploring Engineering sectors, processes, machines and tools.

Unit 1: You will work with a brief that has previously been set by the examination board and you will need to demonstrate your ability to interpret Engineering drawings in order to manufacture the components required.

# Yr 11: Level 1/2 Vocational Award in Engineering (Technical Award) Assessment year

## Unit 1: (40% of final grade)

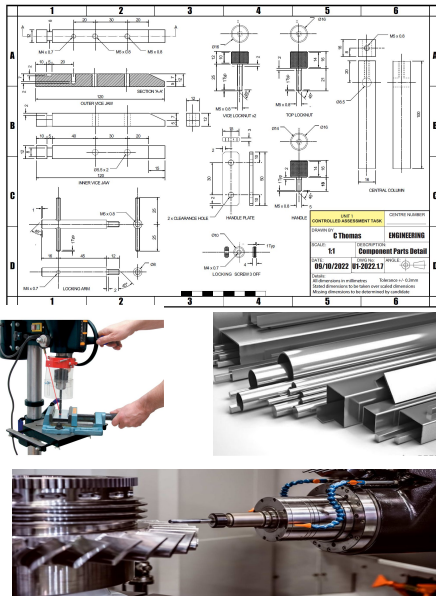

*Unit 1 provides learners with the opportunity to interpret different types of engineering information in order to plan how to produce engineering products. Learners will develop knowledge, understanding and skills in using a range of engineering tools and equipment in order to produce and test an end product.*

## Unit 2: (20% of final grade)

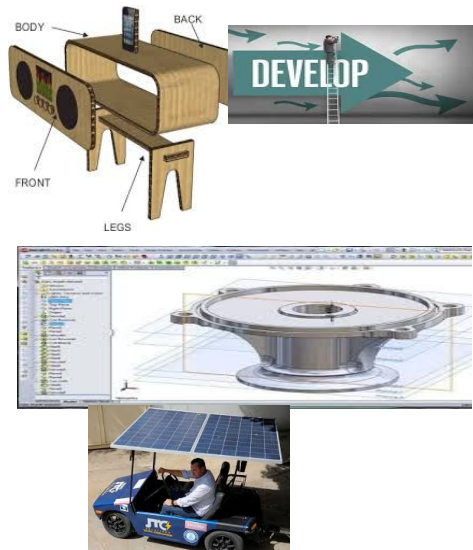

*Unit 2 allows learners to explore how an engineered product is adapted and improved over time, and it offers learners the opportunity to apply their knowledge and understanding to adapt an existing component, element or part of the engineering outcome that they produced for Unit 1.*

## Unit 3: (40% of final grade)



*Unit 3 introduces learners to a range of considerations that impact on engineering design and how modern engineering has had an impact on modern day life at home, work and in society in general.*